



Colour-free body care balm for dry and demanding skin

New formula
with Sheabutter

esemtan[®] dry skin balm

Our Plus

- rich skin care
- moisturizing
- easy to spread
- perfectly compatible with desderman[®] pure und desmanol[®] pure
- colourfree and pleasant scent
- dermatologically tested

Application areas

- for application on clean and dry skin
- special skin care for dry and demanding skin
- suitable for hand and body care

Product Profile

- water- in-oil emulsion
- contains Sheabutter, which restores the smoothness and regulates the moisture content of the skin
- has a calming and moisturizing effect on the skin

Instructions for use

Apply product and rub into the skin.

For daily hand and body care.

To ensure a hygienic use, the RKI recommends the use of dosing pumps or dispensers.

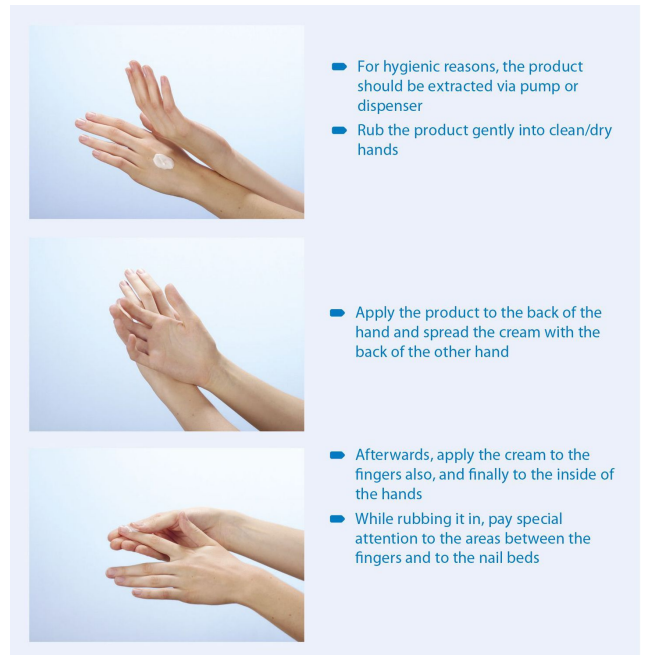

esemtan[®] dry skin balm

Product data

Ingredients:

Aqua, Paraffinum Liquidum, Caprylic/Capric Triglyceride, Glycerin, Polyglyceryl-2 Dipolyhydroxystearate, Polyglyceryl-3 Diisostearate, Butyrospermum Parkii Butter, Zinc Stearate, Magnesium Sulfate, Tocopherol, Parfum, Potassium Sorbate, Sodium Benzoate, Citric Acid

Chemical-physical data

Color	white
Density	approx. 0,98 g/cm ³ / 20 °C
Flash point	Not applicable
Form	emulsion
pH	Not applicable
Viscosity, dynamic	approx. 3.000 mPa*s / 20 °C / Method : DIN 53019

Environmental information

schülke manufactures products economically and with advanced, safe and environmentally friendly production processes while at the same time maintaining out high quality standards.

Expert opinion and information

Please visit our website for an overview of all available literature/reports on the product: www.schuelke.com.

For individual questions:

Application Department

Phone: +49 40 52100-666

E-Mail: info@schuelke.com

Special advice

Protect from sunlight.

Only store at room temperature.

Possibly occurring settling of ingredients is completely reversible by shaking and does not affect the product quality.

Information for order

Item	Delivery form	Item no.
esemtan dry skin balm 150 ml FL	30/Carton	on request
esemtan dry skin balm 500 ml FL	20/Carton	on request

These products are not available in every country. For more information please contact our local subsidiary or distributor.

Application aids

Application aids	Item no.
Dispenser KHK 500 (approx. 0.75-1.5ml per stroke)	669600
Product dispenser long arm 500 ml	669610
sm 2 500 (approx- 1.0-3.0ml per stroke)	668600
sm 2 Universal (approx. 1.0 - 3.0 ml per stroke)	668500

Related Products

- esemtan[®] active gel
- esemtan[®] cleansing foam
- esemtan[®] skin lotion
- esemtan[®] wash lotion
- esemtan[®] wash mitts



Schülke & Mayr GmbH holds a Manufacturer's Authorisation according to sect 13 para 1 German Drug Law and Certificates of GMP Compliance for medicinal products.

schülke Headquarters
Schülke & Mayr GmbH
Robert-Koch-Str. 2
22851 Norderstedt, Germany
Phone +49 40 - 52100 - 0
Fax +49 40 - 52100 - 318
www.schuelke.com
info@schuelke.com